

Quick Start Guide

SST1 Hibernation Starter

QSG-SST1-Hib-Starter-Rev 1.0L1E| EN



CAUTIONS & BEST PRACTICES

- If the SST1 Hibernation Starter appears to be damaged or is not functioning in the correct way, then please get in touch with WatchGas or a local representative.
- For indoor and outdoor use.
- Servicing can only be carried out by a WatchGas office or trained service technician.
- Warranty does not cover electrical shock or mechanical shock and/or water damage.

WARNING

IMPORTANT SAFETY INFORMATION: READ BEFORE USE

- To ensure personal safety, read Safety Information and Warnings before using the SST1 Hibernation Starter.
- Use the SST1 Hibernation Starter only as specified by the manufacturer. Failure to do so may impair protection provided by the SST1 Hibernation Starter.
- Follow all required National Electric Codes (NEC) and safety codes.
- Do not attempt to adjust, disassemble, or service the equipment.
- Only use in a well-ventilated space, in normal atmosphere, 20.9% Oxygen and non-hazardous environment.
- Only use three AA (double A) batteries to power the SST1 Hibernation Starter.

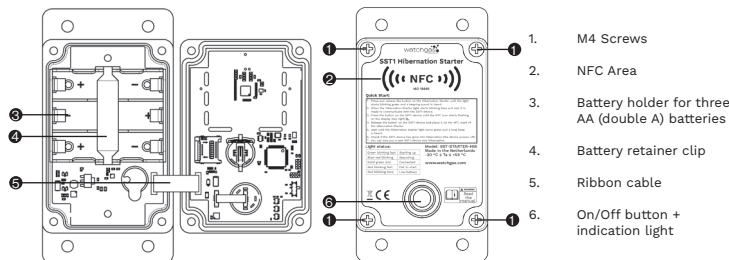

Light Status:

- Green blinking fast:** starting up
- Blue-red blinking:** searching for NFC on the SST1-device
- Solid green:** connected to NFC on the SST1-device
- Red blinking fast:** fail to start
- Red blinking slow:** low battery

Dimensions (LxWxH): 68 x 50 x 132 mm/2.68 x 1.97 x 5.20 in

Weight: 150g/ 5.29 oz (without batteries)

Operating Temperature: -20 - 50 °C/ -4 - 122 °F

Humidity: 10-90 %RH

Ingress Protection: IP67

Storage Temperature: 0 - 40 °C/ 32 - 104 °F

Power Supply: 3x AA batteries. **NOTE:** Only use Alkaline (Zn-MnO₂), Lithium (Li-FeS₂), NiMH (Ni-MH), or NiCd (Ni-Cd) batteries

Device Compatibility: One module compatible with all SST1 devices; SST4 device support may be added in the future

Warranty: 2 Year warranty (not including batteries)

PREPARE FOR USE

1. Place the SST1 Hibernation Starter on a flat surface.
2. Use a screwdriver to loosen the four M4 screws on the front of the unit by turning them counterclockwise, then carefully separate the housing part. Take care not to apply any strain or force that can damage or disconnect the ribbon cable connecting the two circuit boards.
3. Take off the battery retainer clip, and take the three AA batteries included in the box and place them inside the designated spot inside the SST1 Hibernation Starter, taking care to fit them facing the right way.
4. Place the battery retainer clip back on, reinsert all four M4 screws, and tighten clockwise until firmly closed (0.75Nm) to ensure a watertight seal.

MOUNTING INSTRUCTIONS

The SST1 Hibernation Starter can be mounted on any flat surface using screws or tie wraps, either horizontally or vertically. **NOTE:** Do not overtighten the screws and do not use screws that are too large.

HOW TO USE

1. Press and release the button on the SST1 Hibernation Starter until the light starts blinking green and a beeping sound is heard.
2. When the SST1 Hibernation Starter light starts blinking blue and red, it is ready to communicate with the SST1-device.
3. Press the button on the SST1-device until the NFC icon starts flashing on the display (top right) .
4. Release the button on the SST1-device and place it on the NFC mark of the SST1 Hibernation Starter.
5. Wait until the SST1 Hibernation Starter light turns green and a long beep is heard.
6. Check if the SST1-device has gone into hibernation (the device powers off).
7. You can now put a new SST1-device into hibernation.

NOTE: The SST1 Hibernation Starter will automatically turn off if not used for 90 seconds. To indicate that it is still on, it beeps after 60 seconds of inactivity. This timer resets whenever an SST1-device is detected through the Hibernation Starter's NFC.

TROUBLESHOOTING

1. If the SST1 Hibernation Starter is not working, check if the device shows indication lights when turned on: blinking green, followed by blinking red and blue. If not, replace the batteries.
2. If the SST1 Hibernation Starter shows light indication, check if the NFC is turned on on the SST1-device.
3. If the SST1 Hibernation Starter is still not working, try using another SST1-device or SST1 Hibernation Starter to locate the problem. If none of these methods work, contact WatchGas Customer Support for further assistance.

FOR MORE INFORMATION

www.watchgas.com
info@watchgas.com

EMEA

Klaverbaan 121
 2908 KD
 Capelle aan den IJssel
 The Netherlands

APAC

Woods Square Tower 1,
 12 Woodlands Square,
 #11-71, Singapore 737715



Americas

313 N. State Hwy 342
 Red Oak, TX 75154
www.watchgasusa.com
info@watchgasusa.com

ANZ

aus@watchgas.com